

**sakumetall**

## EXTERNAL STEEL HATCH Q OUTWARD OPENING

ver01

### Recommended use

External hatch used in residential buildings, multi-storey apartment buildings, industrial buildings or offices.

### CE-marking

Hatches meet the requirements according to the product standard EVS-EN 14351-1:2006+A1:2010.

### Dimensions

Maximum dimensions of the hatch frame are 1410 x 2910 mm and minimum dimensions are 450 x 500 mm.

### Properties

Watertightness, EN 1027, class*	3A
Air permeability, EN 1026, class*	4
Resistance to wind load, EN 12211, class*	C4
Sound insulation $R_w$ , EN ISO 140-3, EN ISO 717-1*	34 dB
Resistance to repeated opening and closing, EN 1191, class*	5; 100000 cycles

\*Declared values depend on the size of the hatch.

### Construction

**Hatch leaf** is 64 mm thick. Rebates are at all sides. External and internal sides are made of 1,0 mm hot-dip galvanized steel sheets connected with rivets. Insulation material is mineral wool. There are 2 hinges with ball bearings.

**Frame** is made of hot-dip galvanized steel sheet profiles with a thickness of 1,5 mm, connected at the corners with screws and rivets. Frame can be ordered with cover slat covering lateral installation slots (type YM) or without cover slat for recessed installation (type YS). Seal is made of silicon rubber and is fitted into the groove of the frame.

### Finish

Hatch is coated with epoxy powder primer and polyester powder coating. Standard tones are RAL7001 (silver gray), RAL7024 (graphite grey), RAL8014 (sepia brown), RAL9006 (white aluminum) and RAL9010 (pure white). Alternatively the hatch can be painted with epoxy primer and two component polyurethane paint in all the tones of RAL catalogue.

### Locks

Hatches can be equipped with locks from well known companies such as Abloy, Boda, Assa and Nemef.

### Installation

Frame is fixed from at least four points. Fixing apertures are covered with plastic plugs. Installation gap will be filled with mineral wool or construction foam after fixing. Package includes fixings and plugs. For more details see installation manual.

### Accessories

- window, peephole, ventilation grill
- lock case, core, core covers, door handle, door closer
- border slats

### Maintenance

Hatch must be checked and maintained at least once every six months. Check closing of hatch and operation of locking elements. Detailed information is available in maintenance manual. It is possible to sign a maintenance contract upon purchasing the hatch.

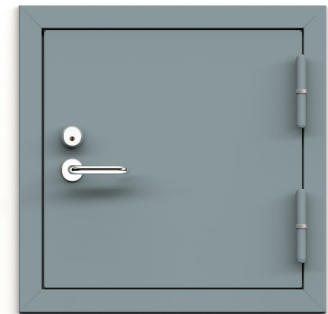

Frame type YM

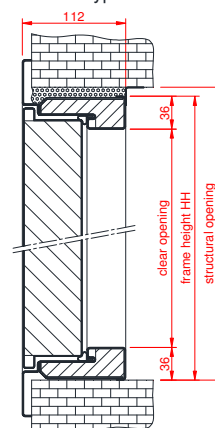

Frame type YS

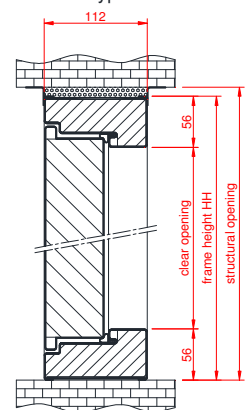

Frame type YM

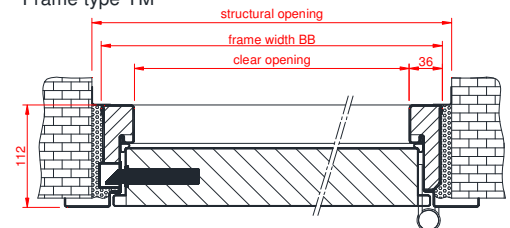

Frame type YS

